



101 Lucas Valley Road, Suite 300
 San Rafael, CA 94903
 Tel.: 415-472-1734
 Fax: 415-499-7715
 www.LGVSD.org

MANAGEMENT TEAM
 General Manager, Curtis Paxton
 Plant Operations, Mel Liebmann
 Collections/Safety/Maintenance, Greg Pease
 Engineering, Michael P. Cortez
 Administrative Services, Dale McDonald

DISTRICT BOARD
 Megan Clark
 Craig K. Murray
 Barry Nitzberg
 Gary E. Robards
 Crystal J. Yezman

ADDENDUM NO. 1

Date: August 29, 2024
 Project: **Center Pivot No. 4 Replacement**
 Job No.: 25580-02

To: All Planholders and Prospective Bidders

The following changes and/or clarifications are hereby made to the Contract Documents and shall become a part of the Contract Documents dated August 2024.

1. License Requirements: A **Class A General Engineering** California contractor’s license is required to bid on the project.
2. Project Description & Scope of Work: The project description has been revised as follows to correct an error in the base radius of the center pivot, which is highlighted on the attached as-built drawing for clarity. All base pivot radius of “825’-diameter” referenced in the Contract Documents shall be replaced with “**665’-diameter.**”

“Replacement of existing ~~825’-diameter~~ **665’-diameter** Center Pivot No. 4 irrigation system and ancillary components.”

This addendum consists of two (2) pages including this page and attachments. Acknowledge receipt of this addendum in the space provided on page 13 of 133, Proposal and Bid Schedule, of the Bid Forms, and by signing in the space provided below. Submit an original copy of this addendum cover page along with the bid. Failure to do so may disqualify the bidder.

Las Gallinas Valley Sanitary District: Bidder: _____

Michael P. Cortez, PE, District Engineer (Authorized Signature) _____ (Date)

**AS-BUILT DRAWINGS
SHEET 1 OF 2**

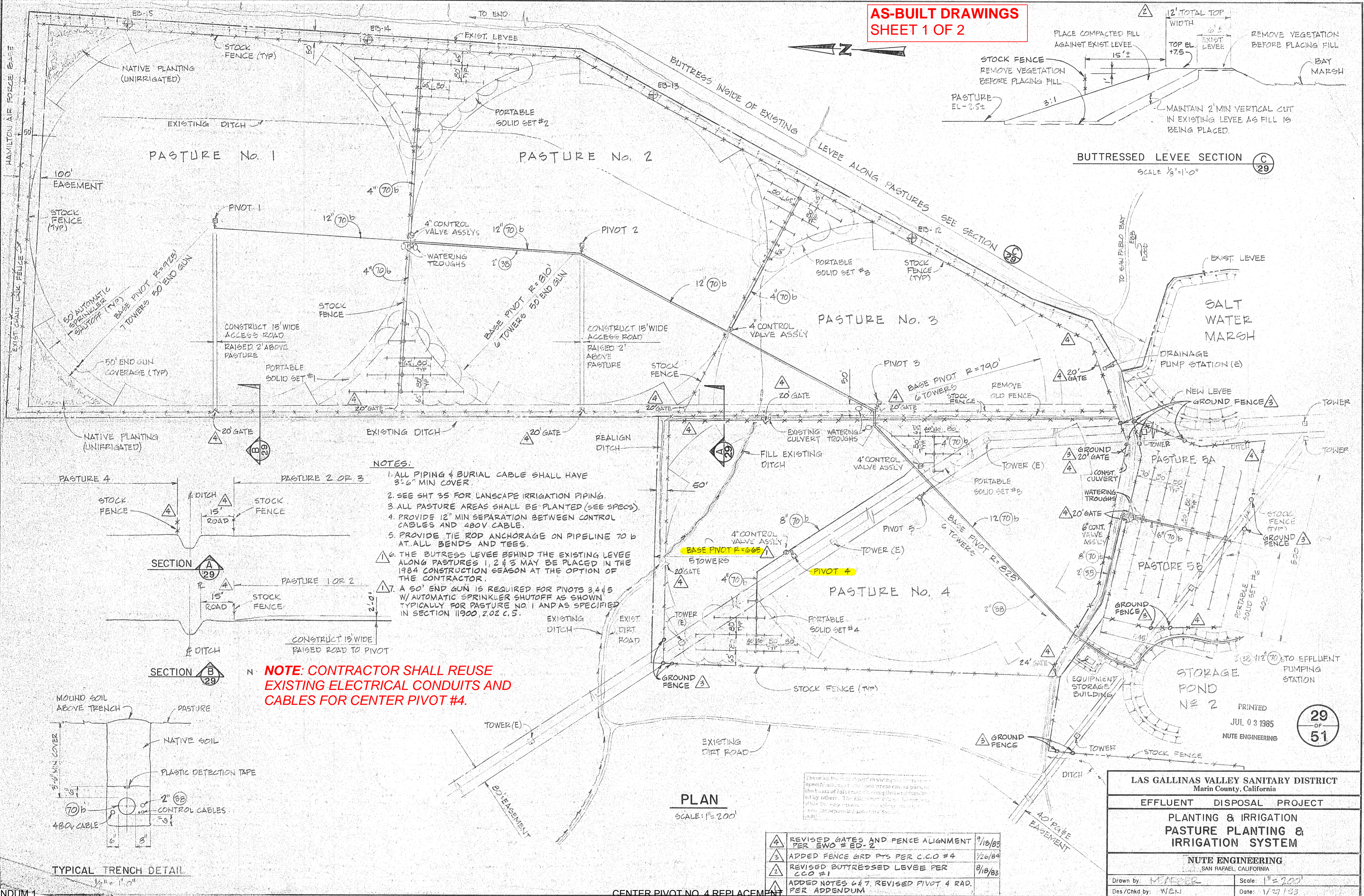

- NOTES:**
1. ALL PIPING & BURIAL CABLE SHALL HAVE 3'-6" MIN COVER.
 2. SEE SHT 35 FOR LANDSCAPE IRRIGATION PIPING.
 3. ALL PASTURE AREAS SHALL BE PLANTED (SEE SPECS).
 4. PROVIDE 12" MIN SEPARATION BETWEEN CONTROL CABLES AND 480V CABLE.
 5. PROVIDE TIE ROD ANCHORAGE ON PIPELINE 70 b AT ALL BENDS AND TEES.
 6. THE BUTTRESS LEVEE BEHIND THE EXISTING LEVEE ALONG PASTURES 1, 2 & 3 MAY BE PLACED IN THE 1984 CONSTRUCTION SEASON AT THE OPTION OF THE CONTRACTOR.
 7. A 50' END GUN IS REQUIRED FOR PIVOTS 3, 4 & 5 W/ AUTOMATIC SPRINKLER SHUTOFF AS SHOWN TYPICALLY FOR PASTURE NO. 1 AND AS SPECIFIED IN SECTION 11900, 2.02 C.S.

NOTE: CONTRACTOR SHALL REUSE EXISTING ELECTRICAL CONDUITS AND CABLES FOR CENTER PIVOT #4.

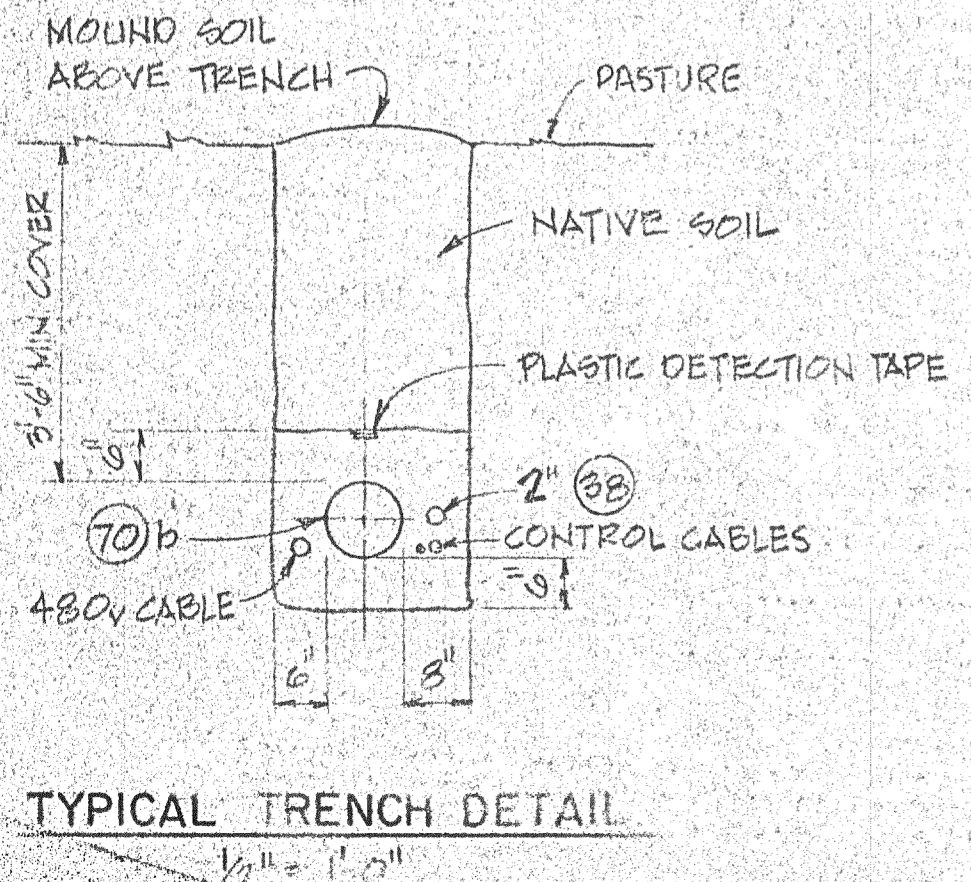

PLAN
SCALE: 1" = 200'

4	REVISED GATES AND FENCE ALIGNMENT PER EWO # ED-2	9/10/83
3	ADDED FENCE GRD PTS PER C.C.O #4	1/26/84
2	REVISED BUTTRESSED LEVEE PER C.C.O #1	8/18/83
1	ADDED NOTES 6 & 7, REVISED PIVOT 4 RAD. PER ADDENDUM	

LAS GALLINAS VALLEY SANITARY DISTRICT
Marin County, California

EFFLUENT DISPOSAL PROJECT

PLANTING & IRRIGATION PASTURE PLANTING & IRRIGATION SYSTEM

NUTE ENGINEERING
SAN RAFAEL, CALIFORNIA

Drawn by: *WEN* Scale: 1" = 200'
Des/Chkd by: *WEN* Date: 1/27/83